

## 5" Coaxial Ceiling Speaker (5W-10W-20W) CSK-520H

### Feature:

- ✓ Commercial ceiling speaker with transformer.
- ✓ Hi-fi range coaxial ceiling loudspeaker with back cover.
- ✓ Ideal for stadium, restaurant, conference room, train station & airport BGM and speech use.
- ✓ High power output range in-ceiling speaker for big scale installation.
- ✓ Rated power output 5W-10W-20W at 100V.
- ✓ Rated power output of 20W RMS.
- ✓ 5" coaxial PP two way driver unit with breathing hole.
- ✓ Line input 100V or 70V.
- ✓ ABS enclosure, metal grille and ABS back cover in white.
- ✓ Flush mount in-ceiling quick and secure installation.
- ✓ Wide dispersion rang installation PA loudspeaker.



### Specification:

<b>Model</b>	<b>CSK-520H</b>
<b>Description</b>	5" Coaxial Ceiling Speaker
<b>Rated Power Output</b>	5W-10W-20W
<b>Line Input</b>	100V or 70V
<b>Frequency Response</b>	100-20KHz
<b>SPL(@1W/m)</b>	88dB
<b>Speaker Unit</b>	5" coaxial PP two way driver unit
<b>Cutout Size</b>	180mm
<b>Dimension</b>	213(D)×130(H)mm
<b>Material</b>	ABS enclosure, metal grille and ABS back cover in white
<b>Mounting Way</b>	Flush mount in-ceiling quick and secure installation
<b>Weight</b>	1.5kg
<b>Packaging</b>	540×500×420mm (8PCS)

### Side View & Dimension:



# 5" Coaxial Ceiling Speaker (5W-10W-20W) CSK-520H

## Mounting Guidance:

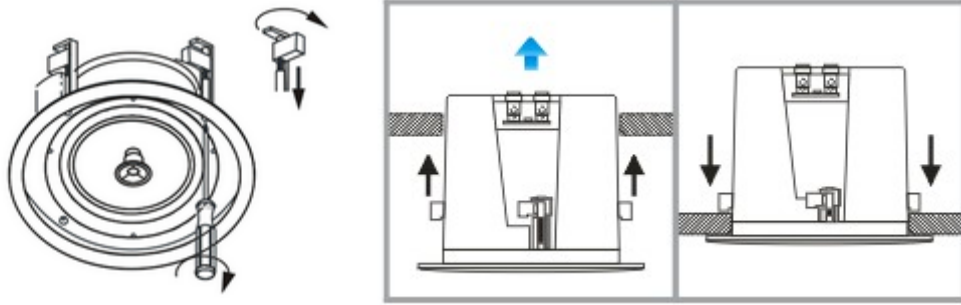

## Frequency Response & SPL Diagrams:

